

RUTLAND STREET

**Site**

- Existing Construction
- New Construction

**Building Usage**

- Apartment
- Commercial
- Cafe | Restaurant | Bar
- Cultural
- Retail
- Residential

SEE DRW NO OPRA-ACM-3A4-ZZ-DR-AR-11006  
(PROPOSED SECOND FLOOR)

OPRA-ACM-Z3A4-ZZ-DR-AR-13000

OPRA-ACM-Z3A4-ZZ-DR-AR-13000

OPRA-ACM-Z3A4-ZZ-DR-AR-13001

OPRA-ACM-Z3A4-ZZ-DR-AR-13001

Riser 2 19'0"

Stair 6 19'0"

Lobby 4 11'0"

Riser 3 9'0"

Stair 5 20'0"

Lobby 5 9'0"

Lift 6 11'0"

Lift 7 11'0"

Open Plan Office 476 80'

Note: All levels referenced to Malin Head Datum  
For site levels refer to Landscape Architects drawings

KEY PLAN

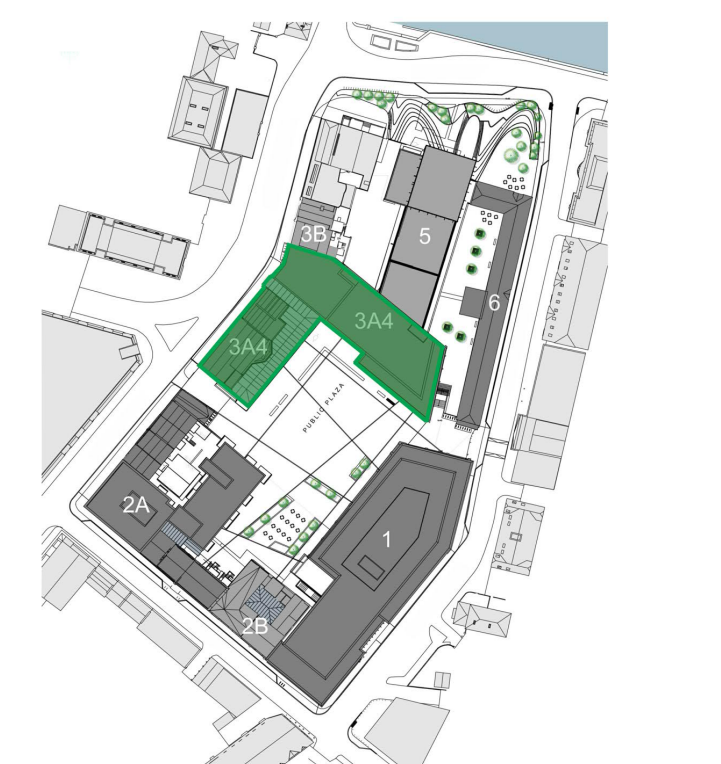

ISSUE/REVISION HISTORY

IR	DATE	DESCRIPTION
1	Jan 2019	Planning Submission

PROJECT NUMBER

60568520

SHEET TITLE

Parcel 3A+4 - Proposed Third Floor - Commercial

1 : 100 @ A0

SHEET NUMBER

OPRA-ACM-Z3A4-03-DR-AR-11007

REV

Project Management Initials : Designer: SP  
Checked: AW  
Approved: SP  
ISO A0 841mm x 1189mm

Last Printed: 1/22/2019 4:28:10 PM  
Filename: C:\Users\lucanham\appdata\local\Documents\OPRA-ACM-3A4-ZZ-ND-AR-001 - lathin.campbell\CCDZ2.rvt  
Printed on: 30 Post Consumer Recycled Content Paper

This drawing has been prepared for the use of AECOM's staff & they shall not be used, modified, reproduced or released by AECOM or its clients without the prior written consent of AECOM. All measurements must be obtained from the stated dimensions.